

# ADDENDUM 1

Tennessee Tech University – Walton House  
February 16, 2026 – 8:00am

ROBERT WAITS – STUDIO TOPOGRAPHY (ST)



## ADDENDUM 1 – Questions and Responses

1. Do the brick and pavers receive a sealant after installation?
  - a. **ST Response – Yes, Provide application of an Impregnator, Non Color Enhancing Sealer. Provide spec sheet for owner and designer approval.**
2. Is crab orchard stone polished or natural?
  - a. **ST Response – Natural Finish**
3. L110, The area noted with 'L', at the bottom of the page L110, this is stair pavers to the pool area. Dr. O has requested to repair some step in this area. See photo attached.
  - a. **ST Response – See revised Comment on L100 referencing stair maintenance**
4. L401, Is the brick wall 6'-0" at the tallest location or will it increase with the grade? How wide is the wall?
  - a. **ST Response – Wall is to be 6' tall at the low end and decrease in height. Top of wall is to stay level.**
5. L501, Consider adding irrigation to the alternate for the planting in the front yard. Is a new sod lawn part of the alternate?
  - a. **ST Response – See revised Sheet L600 for Alternate 1 Irrigation Area.**
6. Will the new trees be staked? Will sod be planted up to the trees or mulched around?
  - a. **ST Response – Trees are not staked. Provide mulch ring slightly larger than the planting pit per tree planting detail on Sheet L503.**
7. L600, Clarify per Legend note: *approval 90 days before install*. Project length is scheduled for 90 days. Is this enough time?
  - a. **ST Response – Reduce schedule length to 14 days to accommodate project schedule.**
8. E1.1, Clarify: Power to be fed from sub panel in basement? 1 is sub panel & 2 is main panel?
  - a. **ST Response – Correct 1 is Sub Panel where electricity is to be supplied.**
9. Possibly replace B-10 at North end of lawn seating area with B13 to balance load better.
  - a. **ST Response – Bid as shown on existing E1.1 drawing.**
10. New note: Existing power and gas at the low wall to be rerouted to the inside out of sight. The concern is it may not be to code. See photo below.
  - a. **ST Response – See revised note on Sheet L100.**
11. L503. The planting sizes... is this the size required at the time of installation?
  - a. **ST Response – Correct, the sizes are required at planting**

END OF SUBMITTED QUESTIONS

## ADDENDUM 1 – Revised Drawings

L100 – Note for Stair Correction, Revised Layout, Existing Gas and Electrical Relocation Note

L600 – Additional Addendum 1 Irrigation Area





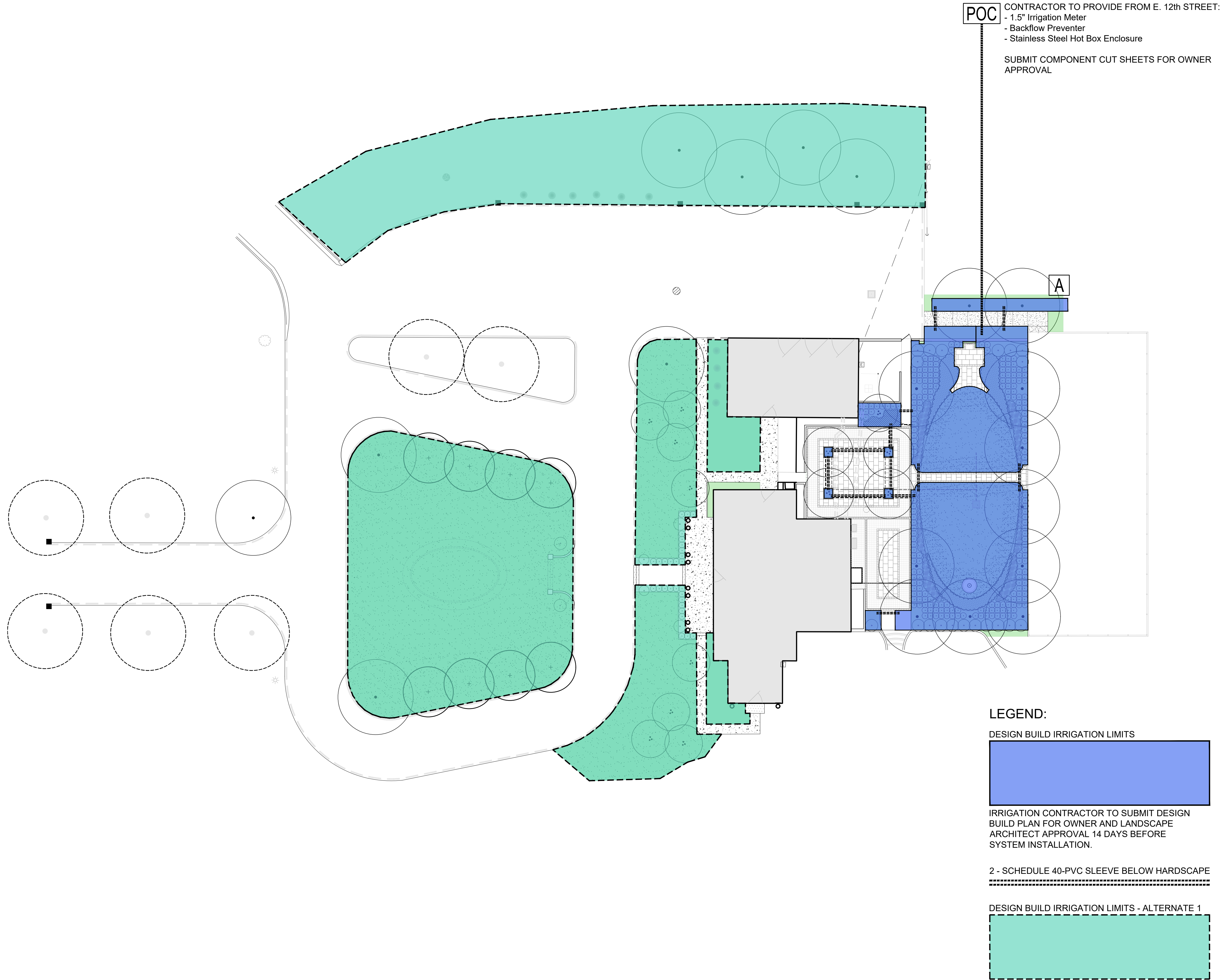

IRRIGATION LEGEND				
SPRAY HEADS				
KEY	RADIUS	PATTERN	GPM @ 30 PSI	HEAD
5F	5'	FULL ☺	.41 GPM	1800prs
5H	5'	HALF ☺	.20 GPM	1800prs
5Q	5'	QUARTER ☺	.10 GPM	1800prs
8F	8'	FULL ☺	1.05 GPM	1800prs
8H	8'	HALF ☺	.52 GPM	1800prs
8T	8'	THIRD ☺	.35 GPM	1800prs
8Q	8'	QUARTER ☺	.26 GPM	1800prs
10F	10'	FULL ☺	1.58 GPM	1800prs
10H	10'	HALF ☺	.79 GPM	1800prs
10T	10'	THIRD ☺	.53 GPM	1800prs
10Q	10'	QUARTER ☺	.39 GPM	1800prs
12F	12'	FULL ☺	2.60 GPM	1800prs
12TQ	12'	3 QUARTER ☺	1.95 GPM	1800prs
12H	12'	HALF ☺	1.30 GPM	1800prs
12T	12'	THIRD ☺	.87 GPM	1800prs
12Q	12'	QUARTER ☺	.65 GPM	1800prs
15F	15'	FULL ☺	3.70 GPM	1800prs
15TQ	15'	3 QUARTER ☺	2.78 GPM	1800prs
15H	15'	HALF ☺	1.85 GPM	1800prs
15T	15'	THIRD ☺	1.23 GPM	1800prs
15Q	15'	QUARTER ☺	.92 GPM	1800prs
15EST	4' X 15'	HALF ☺	.61 GPM	1800prs
15CST	4' X 30'	FULL ☺	1.21 GPM	1800prs
15RCS	4' X 15'	QUARTER ☺	.49 GPM	1800prs
15LCS	4' X 15'	QUARTER ☺	.49 GPM	1800prs
15SST	4' X 30'	HALF ☺	1.21 GPM	1800prs
9SST	9' X 18'	HALF ☺	1.73 GPM	1800prs
ROTORS				
KEY	RADIUS	PATTERN	GPM @ 50 PSI	HEAD
53	53'	ADJUST ☺	9.0 GPM	8005-NP-10
2	39'	ADJUST ☺	3.8 GPM	8005-NP-04
SYMBOLS				
Electronic Valve - Rainbird PEB (mount in green valve box if domestic) (mount in purple valve box if non potable)		⊕	required gpm	zone size
Electronic Master Valve - Rainbird PEB (Provide Rainbird PVC Tee Flow Sensor sized for Irrigation Main) (Wire Flow sensor to ESP - LXMEF Controller)		⊕		M
Bronze Isolation Valve (Manual Valve to match size of Irrigation Main)		⊖		
1" Bronze Quick Coupler (mount in green valve box with locking cover)		⊖		
Irrigation Controller - WeatherTRAK (120 VAC Electric power by General Contractor)		A		
		B		
Irrigation Point of Connection (Provide Irrigation Meter and Backflow Preventer per local codes)		POC		
Typical 4" PVC Sleeve		----		
Typical Irrigation Main		=====		

NOTE:

1. PRE-CONSTRUCTION MEETING WITH IRRIGATION CONTRACTOR, OWNER, IRRIGATION SPECIALIST, AND HORTICULTURAL SPECIALIST TO BE PREFORMED BEFORE CONSTRUCTION

2. MARK LOCATIONS OF ANY EXCAVATION UNDER EXISTING TREE CANOPY AND RECEIVE WRITTEN APPROVAL FROM THE OWNER BEFORE CONSTRUCTION

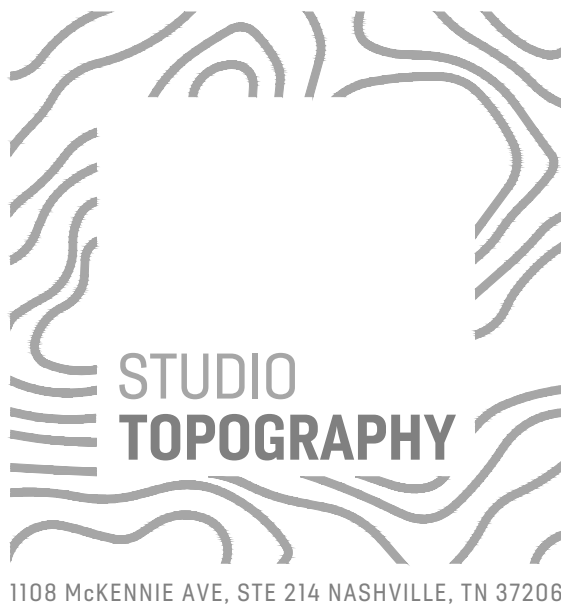
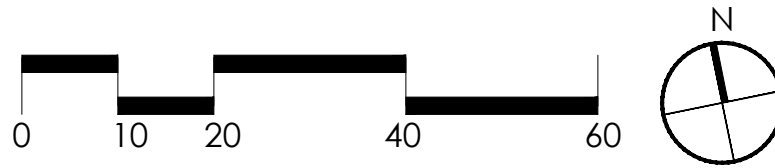

TENNESSEE TECH UNIVERSITY - WALTON HOUSE  
SITE IMPROVEMENTS  
Tennessee Tech University - Cookeville, Tennessee

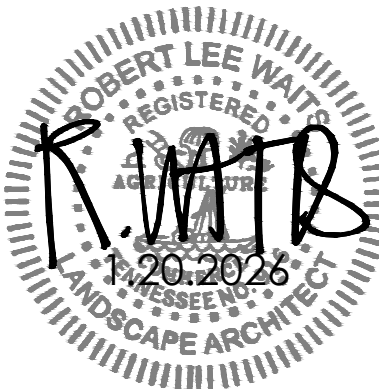

REVISIONS:  
2.16.2026 - Addendum #1

DATE: January 20, 2025  
PROJECT: ST 23-00031  
DESIGNER: RLW

CONSTRUCTION DOCUMENTS

IRRIGATION PLAN

L600